

THE BOOK HILL

The Book Hill is a project about using the book program to connect the surrounding area into a new whole.

THE SITE

The site is characterized by the unfulfilled potentials of the inaccessible Observatory Hill and the programmatically disfunctional Public Library.

The Observatory Hill is a green inaccessible island perforating the urban fabric. The hill is one of the highest points in the city and has a fantastic view above the Stockholm roofscape. But the steepness of the hill renders the hill top under-used.

The current public library consists of one library occupying four separate buildings. Instead of keeping the outdated annexes, we propose to focus on an extension that programmatically brings the library together into one singular whole.

The key in exploiting the potentials of the Observatory Hill and the Public Library, is to create a functional and programmatic composition that solves the internal book program while connecting to both the Asplund Library and the Observatory Hill.

We propose to organize the book program starting from the street level, then rising to the Rotunda and finally

connecting it to the Observatory Hill, thus creating a rooftop park and a transition between the landscape and urban fabric.

ORGANIZATION OF THE BOOK PROGRAM

Fiction and scientific literature is divided in two. Asplund's Library will continue to house the entire fiction collection while the Book Hill is optimized to hold the scientific literature.

The scientific literature is organized according to the Dewey Decimal System starting from 000 to 999. Rather than causing violence to the Dewey Decimal System by compartmentalizing it, we propose to maintain the numerical order throughout the entire Book Hill – like a string of pearls running through the entire library thus forming a continuous boulevard of information. An environment where the urban flaneur can browse for information or engage into some of the informal activities scattered around the library.

ACCESS FOR ALL

The open media collection as well as the rooftop park is based on a seamless continuous surface. In order to climb the Observatory Hill, there is a gentle 1:20 slope making the entire library easily accessible for both elderly and people with handicap.

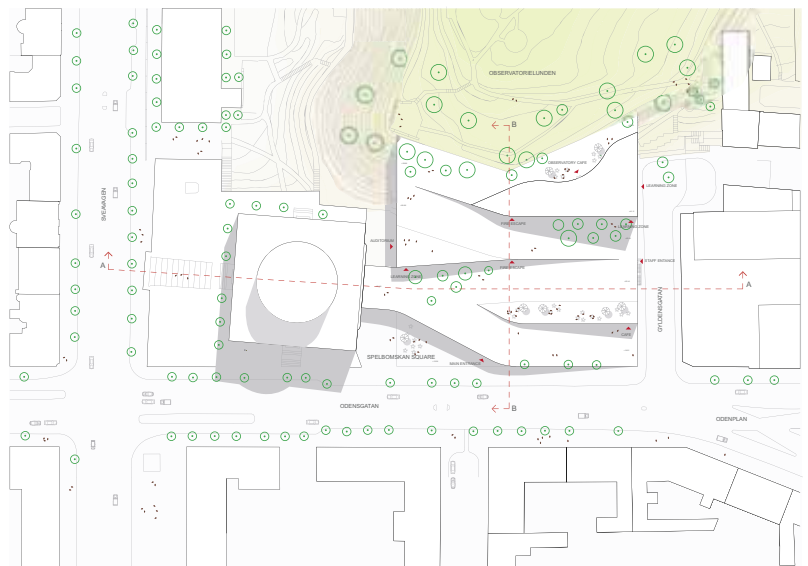
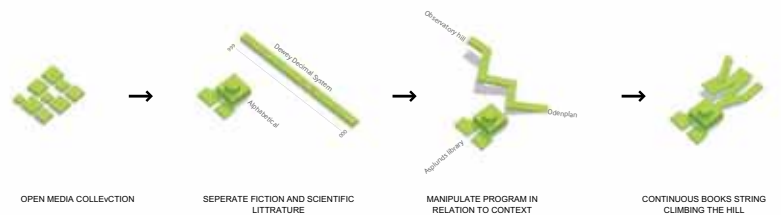

SITEPLAN 1:1000

PROGRAM	ASPLUND	NEW ASPLUND
PUBLIC AREA		
NEW ENTRANCE		587 M ²
NEWS ZONE		344 M ²
LEARNING ZONE		1300 M ²
LECTURE HALLS		945 M ²
CAFE		334 M ²
RESTURANT		560 M ²
UNITS/ADMINISTRATED OFFICES		1676 M ²
OTHER PUBLIC AREA		129 M ²
FICTION	1731 M ²	
CHILDRENS FICTION	662 M ²	
SCIENTIFIC LITERATURE		9080 M ²
MEDIA MANAGEMENT		
DEPOSITORIES	1129 M ²	
SORTING MACHINE		160 M ²
MEDIA MANAGEMENT	52 M ²	887 M ²
LOGISTICS/LOADING		245 M ²
CARETAKERS OFFICE		480 M ²
ADMINISTRATION		
MANAGEMENT	214 M ²	
MARKETING	285 M ²	
OUTREACH ACTIVITIES	248 M ²	
VIRTUAL	120 M ²	
REGIONAL LIBRARY	266 M ²	
STAFF AREA	675 M ²	
INSTITUTE OF BOOKS	1308 M ²	
SUM	6090 M²	16729 M²
TOTAL	23619 M²	

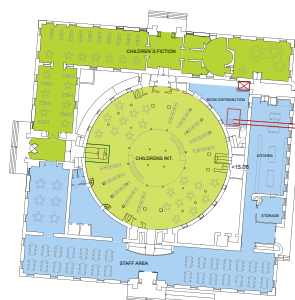

+15.06

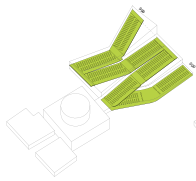
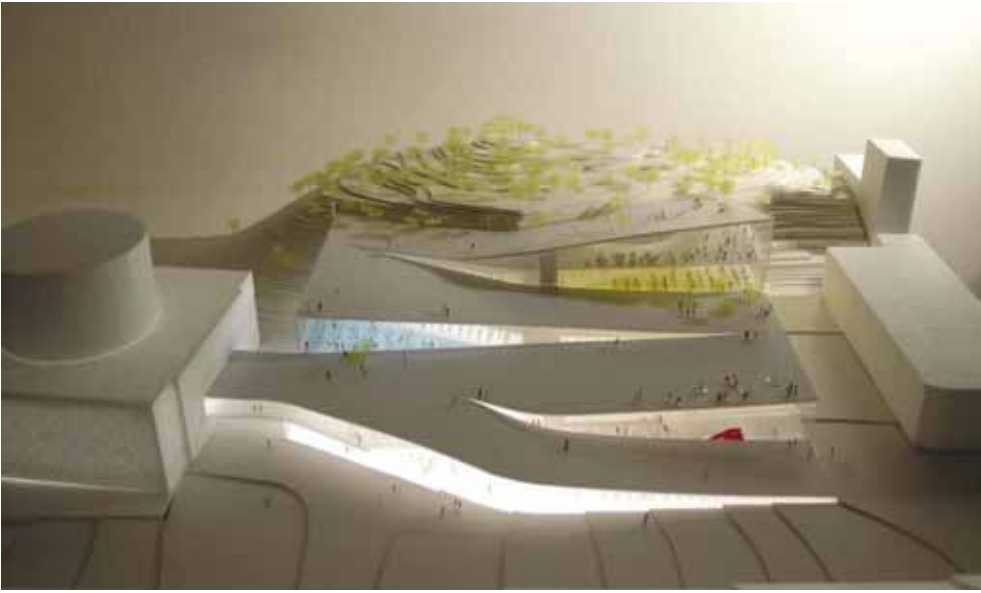

BOOK PROMENADE
FROM 000-999

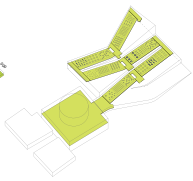

SUPPORT FUNCTIONS FOR
THE BOOKS CONNECTED
TO THE ROTUNDA

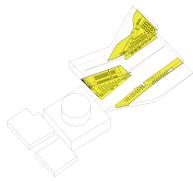

PUBLIC AREA CONNECTED
TO THE ROOF PARK
(POSSIBLE OPEN 24 HRS)

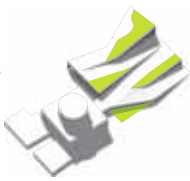

ROOFTOP PARK

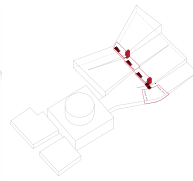

MAIN CIRCULATION AND
CONNECTION

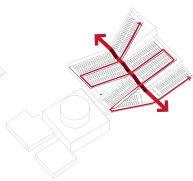

MAIN PUBLIC FLOW

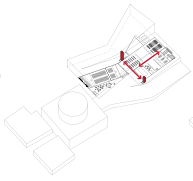

MAIN STAFF FLOW

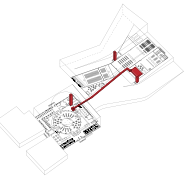

BOOKS SORTING FLOW

